

# IRIS OHYAMA

## Air Circulating Fan

PCF-SC15T

## Operating Manual

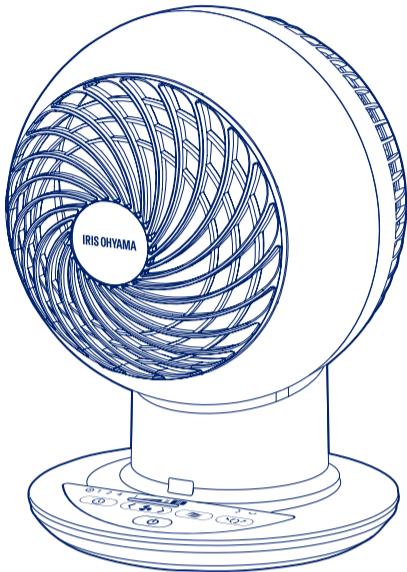

### Table of Contents

#### Before use

Safety Precautions .....	3
Using Places .....	8
Precautions on Using Places .....	8
Part Name .....	9

#### Operation Method

Remote controller .....	10
How to use .....	11
Cleaning and Maintenance.....	14

#### Others

Troubleshooting .....	15
Specification .....	16
Warranty and After-sales Service .....	16
Warranty Card .....	Back Cover

Air Circulating Fan PCF-SC15T		Warranty Card	
This warranty card is a certificate for providing free repair according to the following warranty terms in case of failure within the following period from the date of purchase.			
Date of purchase ※ MM DD YY		Warranty period From the date of purchase: 1 year (except consumables)	
Customer	Name	Shop	Address and shop name
	Address and postal code		
	Tel ( ) - ( )		Tel ( ) - ( )
Instruction to Shop: please fill out items with ※ before handing over the warranty card to the customer.			

#### Carry-in Warranty Terms

- This carry-in warranty starts on the date of purchase and expires in ONE (1) year to cover manufacturing defects caused during a normal use according to the operating manual as well as the precautions stated on the product and packaging.
  - To claim the carry-in warranty service, customers should bring the complete unit and accessories to our service centre in Singapore during the operational hours together with this warranty card and dated original receipt/invoice.
  - If the product is confirmed to be defective by the distributor's authorized personnel, the company at its own discretion may repair or replace the complete or part of the product at no cost.
  - Carry-in Warranty claim will be invalid and repair cost shall be paid by customer in the following situations.
    - Failure and damage caused by improper use and unauthorized maintenance.
    - Failure and damage caused by careless drop after purchase.
    - Failure and damage caused by fire, earthquake or other natural disasters.
    - Failure and damage caused when the product is used for commercial purposes such as used in an industry for a long time, or in a vehicle or a ship.
    - Failure and damage caused by handling, transportation and other processes.
- (f) Failure to show the warranty card and dated original receipt/invoice.  
(g) Date of purchase, customer name, shop name not indicated on the warranty card or altered.  
5. The carry-in warranty services are applicable only for products purchased in South East Asia.

Client : IRIS Ohyama Inc.,  
Address : 2-12-1, Itsutsubashi, Aoba-ku, Sendai-shi, Miyagi-ken, Japan  
Manufacturer : IRIS HOME PRODUCTS(SUZHOU) CO.,LTD  
Address : NO.139 QINGHUA ROAD XUSHUGUAN TOWN,  
SUZHOU NEW DISTRICT,JIANGSU P.R.CHINA

2

786838  
140420\_GCO\_DIM\_01

## Safety Precautions

In order to avoid injuries to you and others as well as unnecessary damage to properties, be sure to read and follow the below "Safety Precautions" carefully. Here, Safety Precautions are described in two aspects: Warnings and Notices. Warnings and Notices are important contents for safe use. Be sure to follow them.

### Explanation of Warnings and Notices Sign



Represents contents to be noted.



Represents contents to be prohibited.



Represents contents that must be performed.



### Warning

Precautions on faulty operation that may cause injury or product damage.



Do not disassemble

- **Do not disassemble, maintain and transform, so as not to cause fire, electric shock, injury and other accidents**  
Please consult the shop where you purchase or IRIS customer service center for maintenance.



Unplug the product

- **In case of exception and failure, please immediately stop using, turn off the power and disconnect the power. plug from the power socket, so as not to cause smoking, fire and electric shock**

Exception examples

- Smell of burning, abnormal sound in operation
- Abnormal heating of power plug and power cord
- Intermittent power-on when moving the power cord
- Frequent stop in operation
- Numb feeling of electric shock when touching
- ➡ Please immediately stop using, and consult the shop where you purchase or IRIS customer service center.



Avoid getting the product wet

- **Do not use this product near water source, bathroom and other damp places**
- **Do not spray water on the main body or immerse the main body into water**  
So as not to cause fire and electric shock.

3

### Correctly use power plug and power cord



Be sure to

- **Please regularly clean dust on the power plug**  
So as not to cause fire and electric shock due to poor insulation resulting from dust accumulation.
- **Be sure to firmly insert the power plug into the socket**  
So as not to cause fire and electric shock due to short circuit.
- **If the power cord is damaged**  
It must be replaced by the professionals of the manufacturer's maintenance department or the similar department in order to avoid danger.



Unplug the product

- **Be sure to disconnect the power plug before product cleaning**  
Maintenance, inspection and movement, so as not to cause electric shock and injury.



Avoid contact with wet hands

- **Do not insert and disconnect the power plug by wet hands**  
So as not to cause electric shock and injury.



Prohibited

- **Do not use power supply beyond 220-240V~**  
So as not to cause electric shock and fire.
- **Do not use damaged power cord**  
Power plug and loose socket, so as not to cause electric shock and fire due to short circuit.
- **Do not break the power cord**
- **Do not damage**  
Process and forcibly bend the power cord or place the heavy object on the power cord, so as not to cause fire and electric shock due to broken power cord.
- **Do not power on in the bundling state of power cord**  
So as not to cause fire.
- **Do not pull the power cord when moving**  
So as not to cause electric shock and fire.

4

## Safety Precautions

Continued



Be sure to

- **This appliance is not intended for use by persons (including children) with reduced physical, sensory or mental capabilities, or lack of experience and knowledge, unless they have been given supervision or instruction concerning use of the appliance by a person responsible for their safety**
- **Children should be supervised to ensure that they do not play with the appliance**
- **If the supply cord is damaged, it must be replaced by the manufacturer, its service agent or similarly qualified persons in order to avoid a hazard**



Prohibited

- **The product is used indoors only**
- **Do not use the product around any article hindering ventilation**
- **Do not cover the product with combustible articles such as clothes, paper or plastic bags before operating**
- **Do not use the product in a place with too much dust or powder**  
Or it may lead to fire.

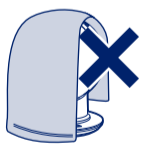

Prohibited

- **Do not use spray (insecticide, hair spray, lubricating oil, etc. )**
- **Do not use this product near kerosene, gasoline, thinner and other flammable liquids as well as objects with sparks and combustible dust, so as not to cause fire**



Prohibited

- **Do not use this product near the curtain etc.**  
So as to avoid damaging surrounding articles and causing injury.



Be sure to

- **Make sure to use it on level and firm floors**  
Or it may lead to personnel injury or damage to surrounding articles due to upside down.
- **Do not use the product in a place near rolled-up curtains**  
Or it may lead to damage to surrounding articles or injury.



### Warning

Precautions on faulty operation that may cause injury or product damage.



Prohibited

- **Do not ride or lean on this product**  
So as not to cause electric shock and injury.



Prohibited

- **Do not blow against persons**  
The air circulating fan compared to a normal fan has relatively high air power. Do not blow against children and the aged to avoid affecting health.
- **Do not blow against pets and plants to avoid affecting pet's health and affect plant growth**



Unplug the product

- **Be sure to hold the power plug part when disconnecting it**  
Do not pull the power cord, so as not to cause electric shock, short circuit and fire due to damage to power cord.
- **Be sure to disconnect the power plug if this product is not used**  
So as not to cause electric shock and fire due to insulation aging.



Prohibited

- **Please do not drag during moving**  
Or it may lead to scratches on tatami or floor.

### Precautions About Battery used in the Remote Control



Be sure to

- **During installation, pay attention to the positive and negative electrodes of the battery, and install it properly according to the instructions**  
So as to prevent the battery from being broken or leakage due to incorrect installation, causing a fire or contaminating the surrounding objects.
- **Remove the battery when it is not used for a long time**  
So as to prevent the battery from leakage, which may cause fire, injury and contamination of the surrounding object  
In the event of a leak, clean the leakage on the battery case and install a new battery.  
If your body accidentally contact with the battery, flush it with plenty of water.



Do not disassemble

- **Do not disassemble the battery**  
Or it may damage the skin or clothing.



Prohibited

- **Do not place and keep with metal objects**  
Or it may cause short circuits due to battery leakage, damage.
- **Do not use batteries other than the specified model**  
So as to prevent the battery from leakage, which may cause fire, injury and contamination of the surrounding objects.
- **Do not charge**  
So as to prevent the battery from leakage, which may cause fire, injury and burns.

7

## Using Places

Please place this product on the flat surface or ground with any obstacles.

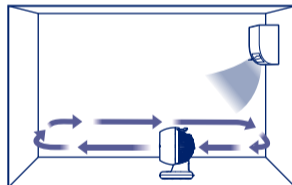

### When using cooling equipment

Turn the circulating fan back to the air conditioner, so that the cool air is fully circulated from top to bottom.

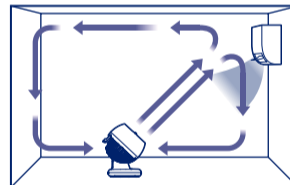

### When using heating equipment

Blow towards the air conditioning direction or blow downwards from the high furniture, so that the hot air at the upper part is circulated.

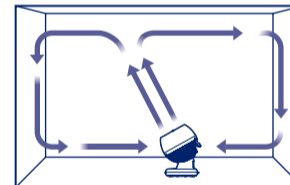

### When circulating

Blow towards the ceiling, so that air is circulating in the room.

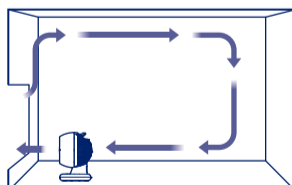

### When ventilating

Exhaust indoor air while sucking outdoor air.

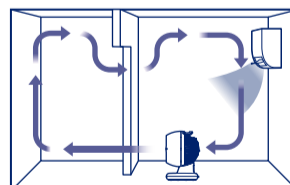

### Circulation in two rooms

Circulate air in two connected rooms.

## Precautions on Using Places

- **Do not place it near direct sunlight places, electric heater**  
Furnace or refrigeration equipment, to avoid product distortion, discoloration and operation exception.
- **Keep this product away from TV**  
Radio and other devices, to avoid electromagnetic interference.

8

5

6

## Part Name

### Front

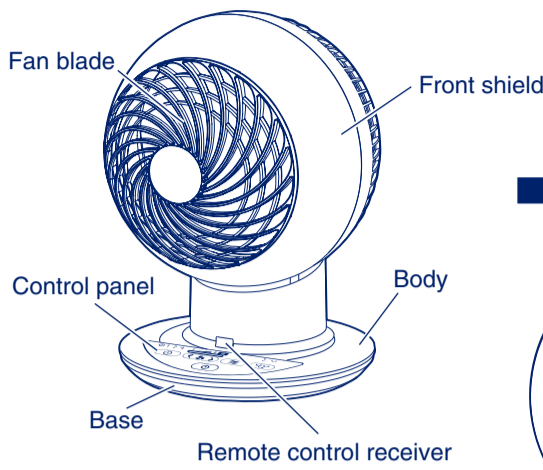

### Back

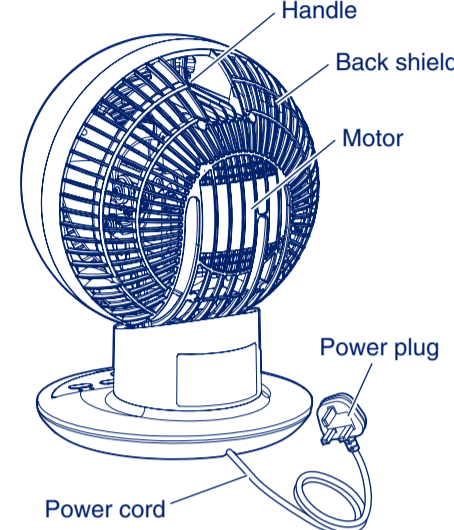

### Control panel

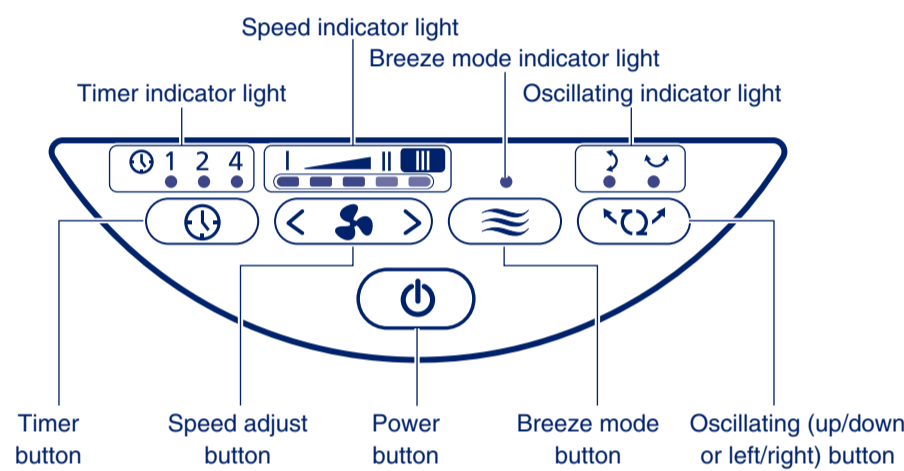

9

## Remote controller

- ※ Please remove the battery [protective film] before use.
- ※ Please align the infrared emission part of the remote controller to the signal receiver of the device.

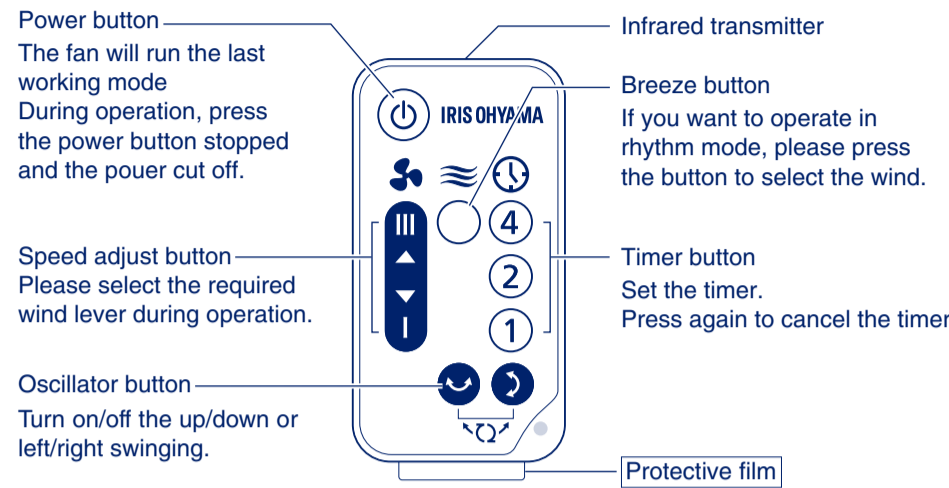

### How to replace the battery

When the operation range of the remote controller becomes smaller and the body does not respond, please replace it with a new battery (CR2025 button battery).

#### 1 Withdraw the battery case

- Hold down the claws in the direction of the arrow and pull the battery case out.

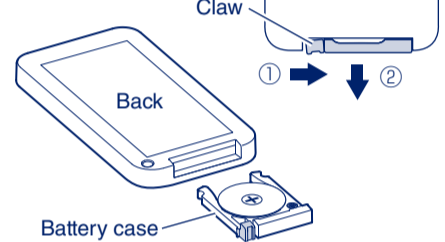

#### 2 Install new battery

- Insert the new battery into the battery case with the correct direction and insert it into the body of remote controller.

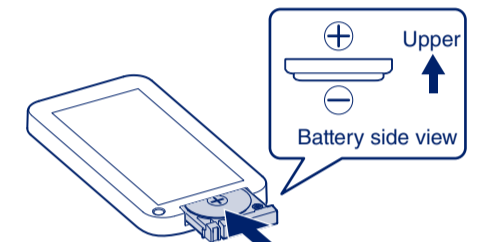

- ※ Do not install the wrong direction.
- ※ Please dispose of used batteries properly.



Attention

- Please read "Precautions About Battery" carefully to avoid battery breakage, leakage, burns, and contamination of the surrounding objects due to improper use.

10

## How to use

### 1 Plug the power plug into the socket

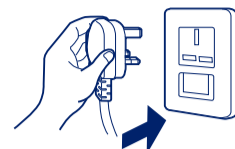

### 2 Press power button

- Run the mode set same as the previous shutdown.
- Please press the power button of remote controller to operate.



### 3 Select the desired operating mode

- Select speed adjust button to switch wind. Each time the button is pressed, the device will make a "click" sound.

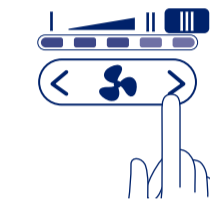

→ Weak ← ... → Strong ↔ Ultrastrong ←

### Stop running

- Press the power button.
- You will hear a beep sound with click and the fan will stop running.



### Breeze

Simulating the breeze by changing wind strength.

- Press the breeze button, the breeze indicator will light up and the product will run in breeze mode.

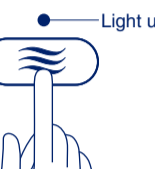

- Press the breeze button again, the natural light indicator will turn off and switch to normal mode. (The fan will restore the gear before the rhythm)

### Oscillating

- When the oscillator button is pressed, the body will make a "click" sound and the indicator will light as below.
- This product can swing up/down or left/right.
- If both up/down and left/right lights are on, the wind will blow in all directions.

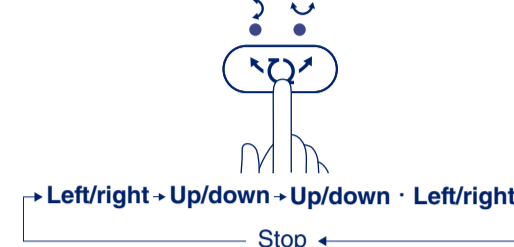

Left/right

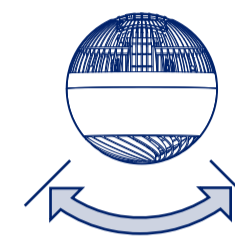

Up/down

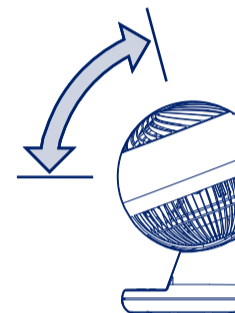

Attention

- Do not manually adjust the swing angle of the up/down or left/right. Be sure to use the swing button to control the operation of the body and change the wind direction.

12

## How to use Continued

### Timer settings

- Every time the timer button is pressed, the body will make a "click" sound, and the indicator light will light up in the order of 1 hour → 2 hours → 4 hours. When the button is pressed again, the setting will be released and the indicator light will be off.

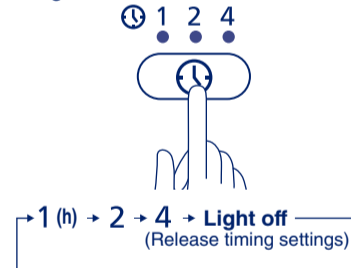

- Press the corresponding timer button while operating with the remote controller to set the timer. If the corresponding timer button is pressed again, the timer setting will be released.
- When the operating time is reaching to the setting time, the body will make a "click" sound, the product will stop operating and the power will be turned off automatically.

13

## Cleaning and Maintenance

Please regularly clean, so as not to cause failure due to dust accumulation.



Warning

- Be sure to turn off the power and disconnect the power plug from the socket before cleaning.
- Clean and maintain when the motor is fully cooled, as it may keep high temperature after use.

- Do not wipe this product with thinner, ethyl alcohol, volatile oil, alkaline detergent, bleaching agent, etc., so as to avoid discoloration, distortion, deterioration and surface breakage or failure.

### Cleaning

- Please wipe with soft rag. When it is not easy to clean, repeatedly wipe with rag dipped with neutral detergent after the rag is fully wrung.

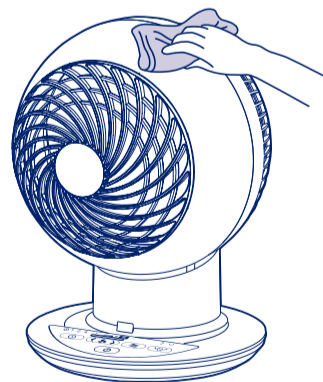

### Storage Method

- When the circulating fan is not used for a long time, please pack it in the plastic bag, and store it in the cool, ventilated and dry place.

14

## Troubleshooting

Before getting the product repaired, please carefully read this operating manual, and inspect whether the malfunction is caused by the following reasons.

Common Fault	Possible Reason	Solution
Not running	● Plug is not inserted into the outlet correctly	● Please reinsert the power plug into the socket firmly.
Unable to operate with remote controller	● Battery exhausted	● Please replace the battery.
	● There is an obstacle between the remote controller receiver and the remote controller	● Please clear obstacles.
	● Remote controller misaligned in correct direction	● Please align the infrared emitter with the remote receiver to the front of the body within a distance of 5m.
Large operating noises	● Unfavorable placing	● Please place it on level ground.
Noises during oscillating	● The sound of the motor may change louder during the pivoting mode, which is the unique operating sound of the motor	● This is normal.
Small wind	● Dust accumulation	● Please maintain the product and clean dust for it.

### If the fault cannot be rectified yet

Please consult the shop where you purchase or IRIS customer service center.



Warning

- Do not disassemble, repair and transform this product at all.

15

## Specification

Rated voltage	220-240V~
Rated frequency	50-60Hz
Rated power	38W
Length of power cord (approximately)	1.8m
Product dimensions (excluding power cord) (approximately)	W210XD210XH290mm (Without power cord)
Product weight (approximately)	2.0kg

※ The product specification is subject to change without notice.

## Warranty and After-sales Service

Be sure to carefully read the following contents.

### Warranty card

Be sure to get the warranty card from the shop where you purchase, and confirm that the relevant items have been filled out. If the warranty card cannot be shown within the warranty period, the maintenance cost will be paid. So please properly keep it.

### Within the warranty period

Warranty period: one year from the date of purchase. The company will maintain for free according to Warranty Terms if failure occurs within the warranty period.

### Beyond the warranty period

Please consult the shop where you purchase or IRIS customer service center. It is necessary to pay the relevant maintenance cost.

### About the warranty period for components

The warranty period for the important components of the product shall be one year after the company suspends production.

### About after-sales service

For other after-sales services not mentioned here, please consult the shop where you purchase or IRIS customer service center.

16